

Phlebotomy Tube Preparation System

HENd



This labeler is ready for use with TPC OHCIS at the Blood Taking section (direct swap with ordinary label printer)

HENd

HENd is a small labeler that automatically attaches the sample information printed label to the tube and provides the patient information printed label. The software's user interface makes blood collection tasks more convenient, such as calling patients, verifying patients, checking sample information, and checking statistics.

Automated barcode labeling | Prevention of human errors due to manual operation | Efficient blood collection process

No need to put it in order!

There is no need to sort the tube in advance, just insert the tube and HENd will automatically recognize it and label the tube with the appropriate sample information and patient information label.

* Up to 5 tubes can be placed on the inlet.

- ✓ Convenient tube insertion
- ✓ Automatic tube detection
- ✓ Various tubes compatible
- ✓ Small labeler
- ✓ Fast tube ejection speed



Attachable, removable tray provided



Prevent medical accidents





Cut down waiting time

Cost reduction

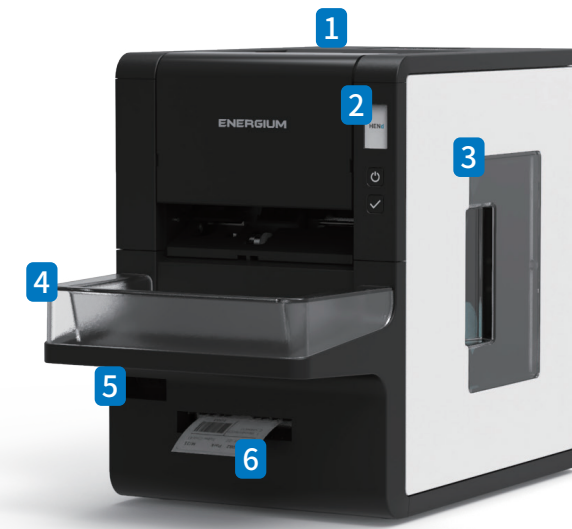
Improve operation efficiency

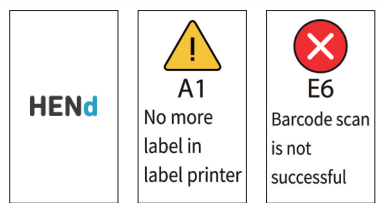
HENd Components



 <p>1 Tube Inlet This is the tube inlet to put the tube to be labeled.</p>	 <p>2 LCD Display Displays the equipment power status, operation status, and alarm/error status.</p>	 <p>3 Label printer Prints the sample label to be attached to the tube, blood collection information, and a label required for patient identification.</p>
 <p>4 Tube outlet There are two types of trays for tube outlet : attached/removable.</p>	 <p>5 Barcode scanner You can check and verify the quantity of samples and labels by recognizing barcodes on sample tubes, receipts, and patient identification labels.</p>	 <p>6 ELP outlet This is the outlet through which the label printed with patient information is discharged.</p>

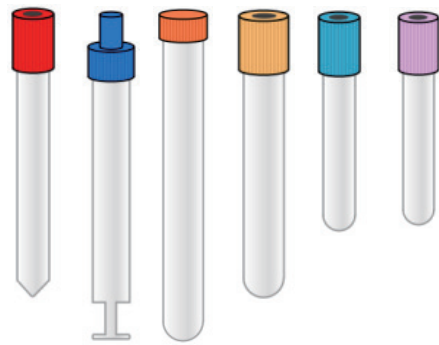

Various tubes compatible

Diameter 13~18mm and length 82~128mm support various tubes mainly used in blood collection rooms.

- Tube type recognition (length, diameter, cap color)
- Provides notification function in case of tube cap color mismatch
- Automatically label to fit the tube type

Double check with two built-in scanners

The internal scanner scans the fed tube to ensure that the correct label is attached, and the separately ejected label is scanned into the external scanner to check the patient and sample information required for blood collection.



- Tube thickness/length/cap color recognition
- Prevention of incorrect label application with label placement detection system
- Inquiry and reprinting of tube, label and patient information

Easy & Convenient Software Program

Dedicated HEND software program can be linked with the LIS to perform tasks such as receiving blood collection, calling, patient management, and statistics management.

- Provides automatic patient call and automatic blood collection function
- Provide statistics according to blood collection room operation
- Provides patient verification function



- Test Items
- Blood Volume By Period
- Time Statistics by Patients
- Blood Collection History
- Number of Patients by Phlebotomist
- Tube usage per Inlet

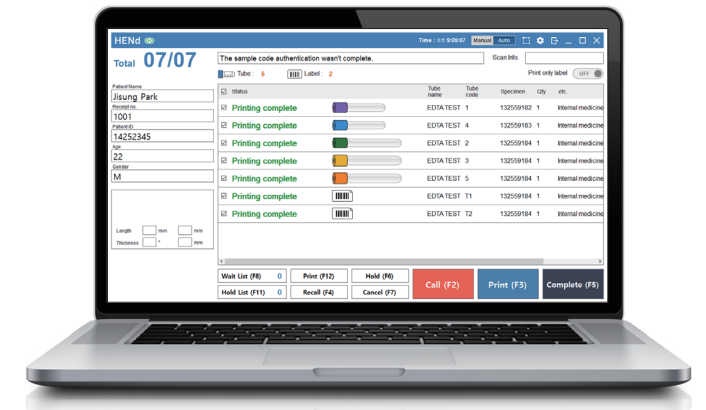

Label attachment position detection system

Label attachment position detection system is function that detects the position of the original label before labeling, the clear window is ensured, allowing phlebotomists to check the volume of collected blood samples.

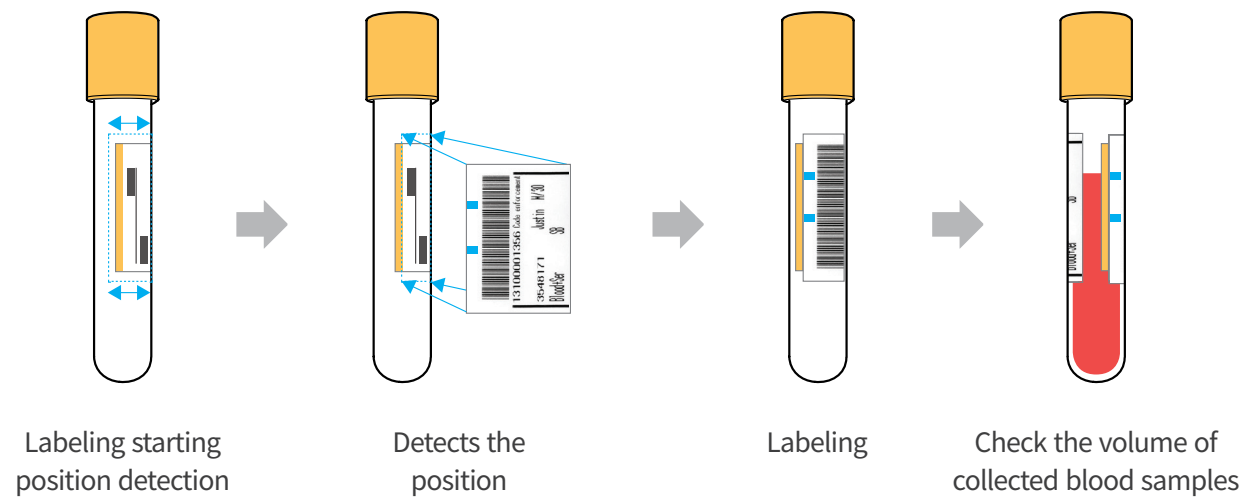

Tube cap color detection system

The tube cap color detection system detects the unique color of the tube cap, checks whether the tube with the color preset by the user is properly inserted, and sounds an alarm when there is a discrepancy. If the phlebotomist inserts another tube, HEND can detect it and prevent mistakes in advance.

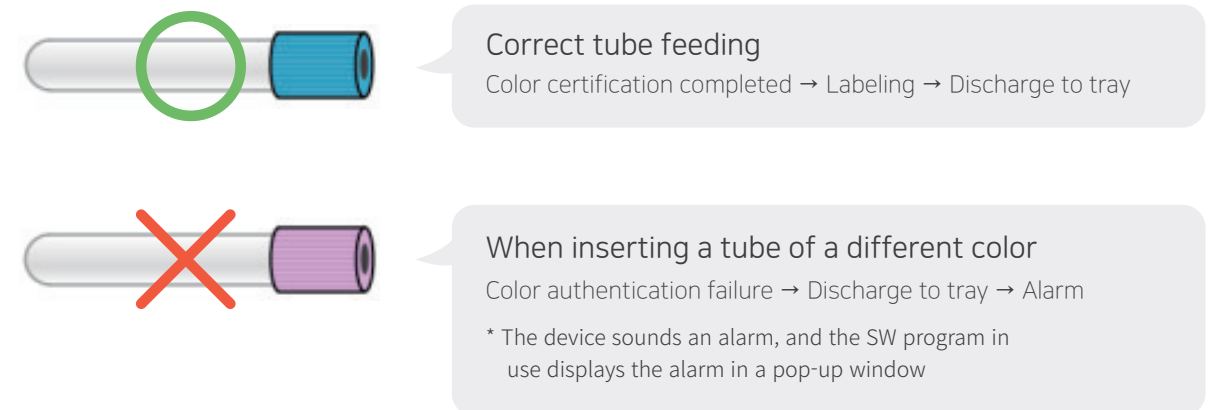

Easy to use

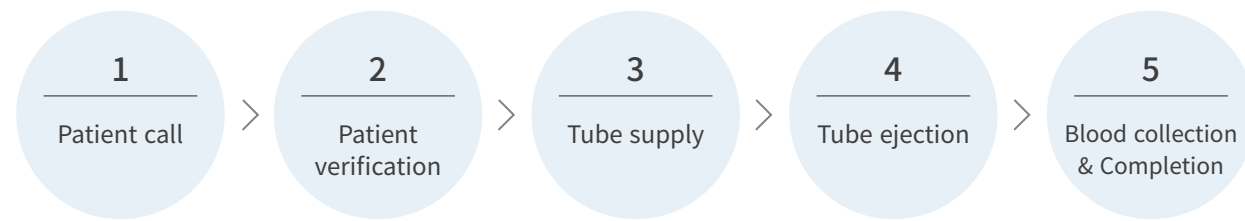

1. Patient call

Click the 'Call' button to call a patient waiting for blood collection.

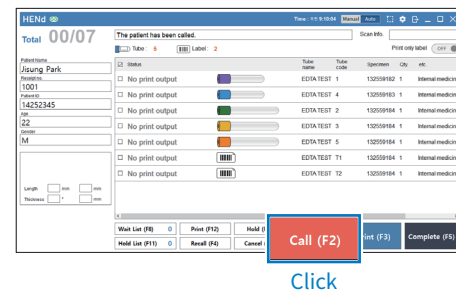

2. Patient verification

(*Verification can be omitted)

The barcode scanner recognizes the receipt brought by the calling patient to verify the patient.



3. Tube supply

Check the list of tubes required for blood collection in the MOD program, and place the tube prepared according to the patient's blood collection information.

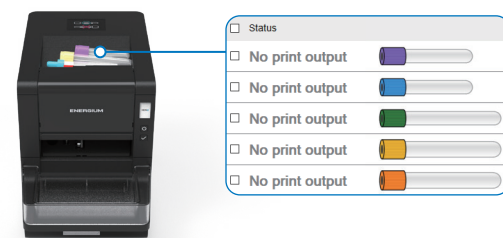

4. Tube ejection

Click the Print button, the labeled tube and patient information printed label are ejected.

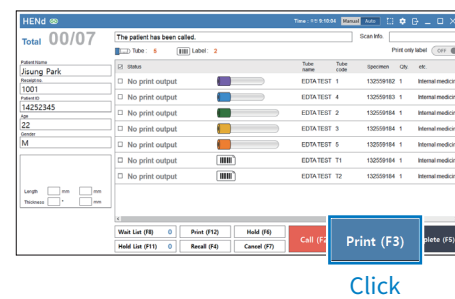

5. Blood Collection & Completion

After collecting blood from the patient, click the Done button in the MOD program to complete the blood collection operation.

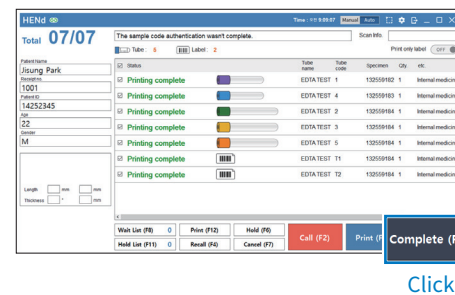

Specifications



190mm



354mm

267mm



Model Name	HEND	
Maximum tube feed quantity	5ea	
Tube ejection speed	3.5sec	
Tube Supply Method	Direct tube supply	
Compatible Tube Types	Diameter : 13~18mm / Length : 82~128mm	
	Manufacturer : BD, GREINER, IMPROVE, VACUTEST KIMA, AMPULAB, INSEPACK, Sarstedt, etc. - Please consult with ENERGIUM regarding tube compatibility prior to use. (only available for verified and tested glass Tube)	
Printing Resolution	Label Printer	203dpi
	Extra Label Printer	
Label Printing Method	Thermal Printing	
Compatible Label Size	Width : 36mm~50mm, Length : 22~35mm, Label Quantity : 1,000 label (per 1 label roll)	
Product Dimension	190(W) x 267(H) x 354(D) mm	
Product Weight	6.5kg	
Power	DC 24V 3A	
Interface	USB	
Others	<ul style="list-style-type: none"> - Label attachment position detection system - Reprint function - Tube type recognition (length, diameter, cap color) - Barcode scanner verification 	
Certification	CE, KC, RoHS	

- Above specifications are subject to change without notice.

HENd

[Contact Us\(MA Division HQ\)](#)

B114, 2, Gasan digital 1-ro, Geumcheon-gu, Seoul, Korea | Postcode : 08591 | Tel : +82 2 6445 4422 | Fax : +82 2 6445 4400 | Email : sales@energium.com

© 2022 ENERGIUM Co., Ltd. All rights reserved.

This is a confidential document and may not be photocopied, photographed, scanned, copied, modified, published, or in any way reproduced, disseminated, distributed, or shared without clear written permission from ENERGIUM.